

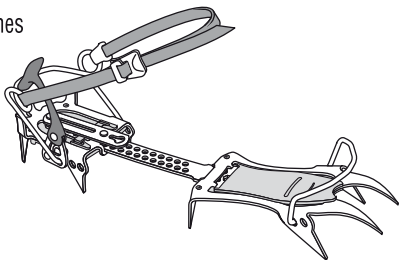

Specific information
part of instructions for use

IRVIS SIDELOCK

- (EN) Crampons
- (FR) Crampons
- (DE) Steigeisen
- (IT) Ramponi
- (ES) Crampones



EN 893

UIAA

2 x 405 g = 810 g

x 10

With reversible linking bars Medium < 8,5 (US)
Avec barrettes reversibles Medium < 42 (FR)

3 year guarantee

T03SL02



price

T03500-D (14047) Recto

SIDELOCK

3. Adjustment

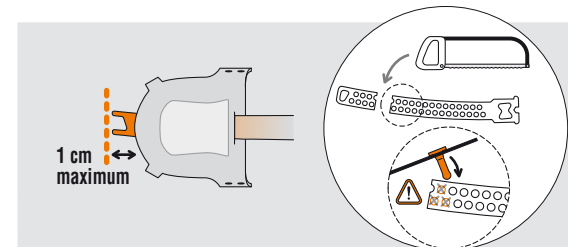
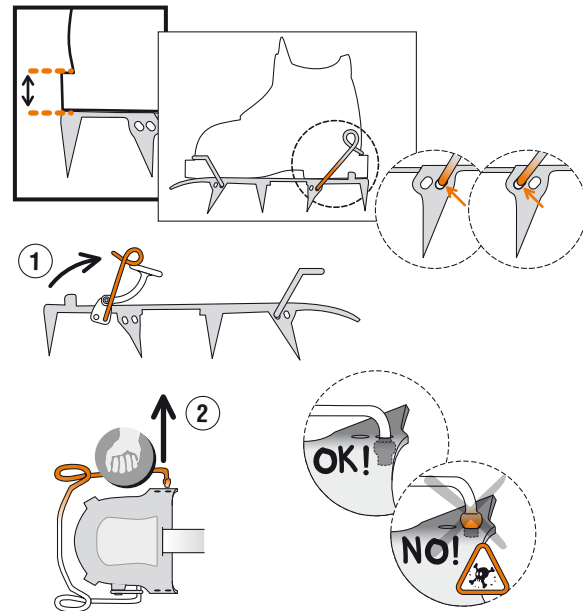
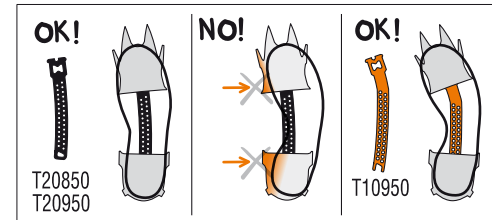
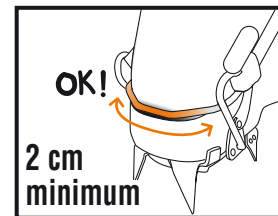
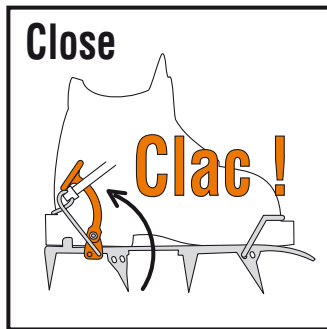
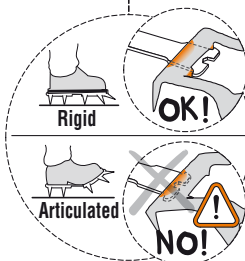
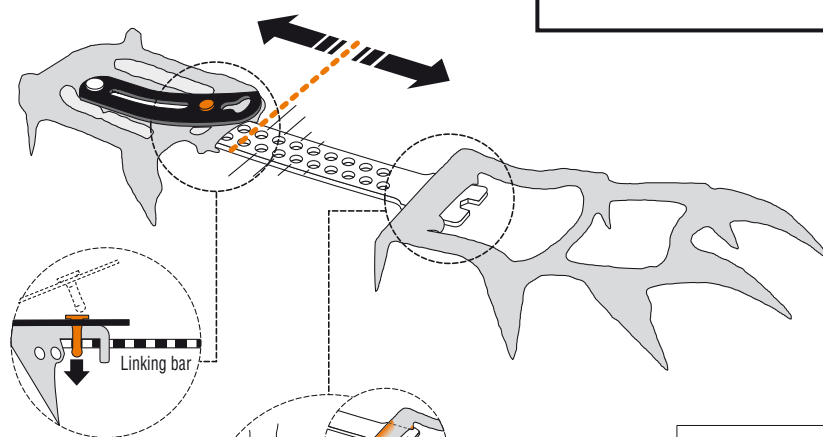
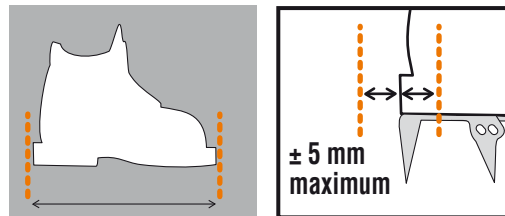
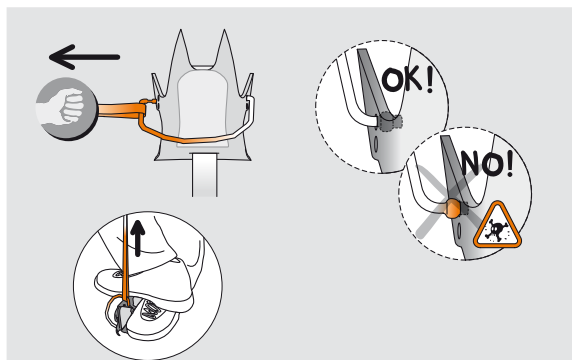
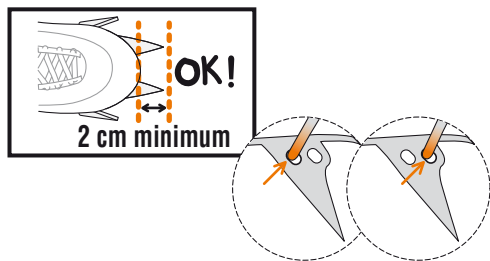
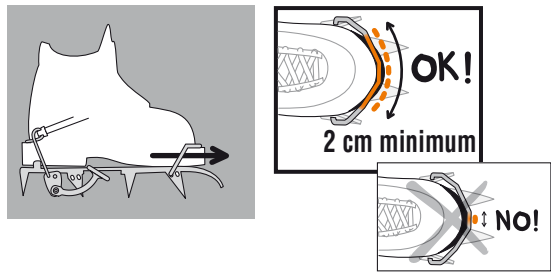

SIDELOCK

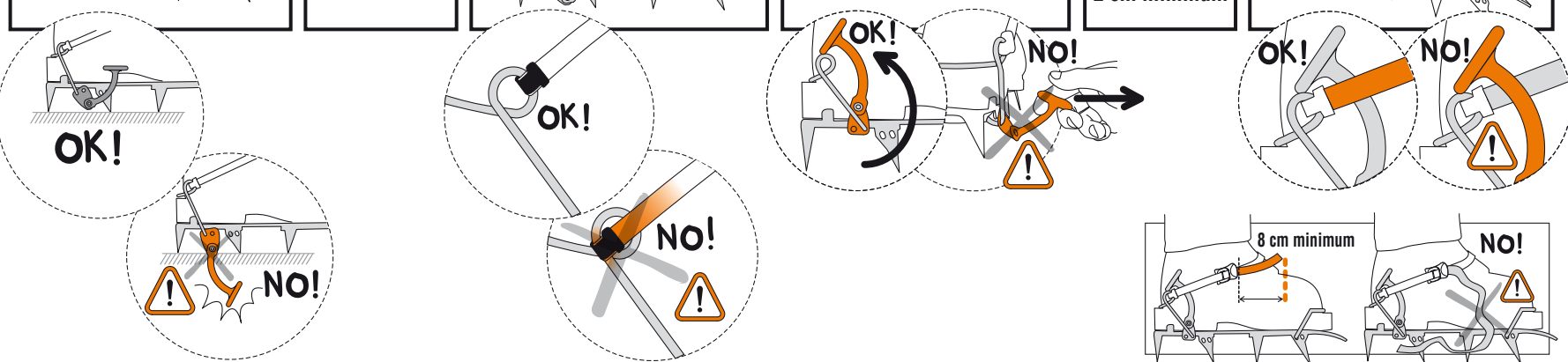
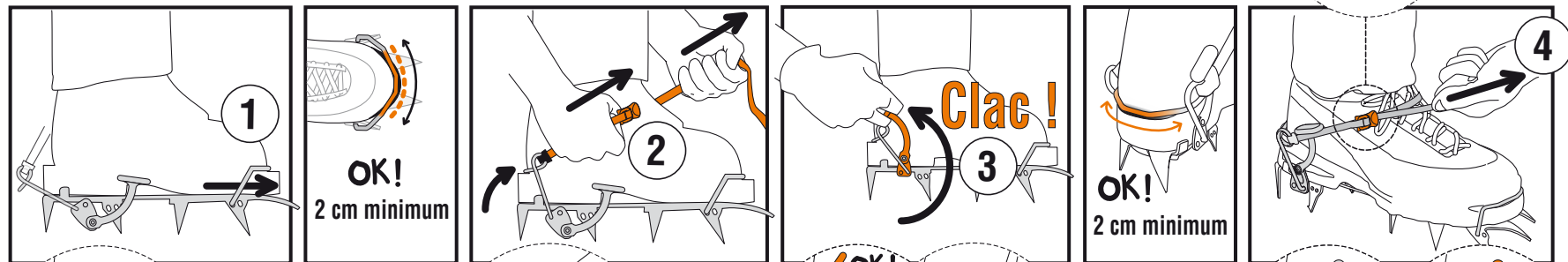
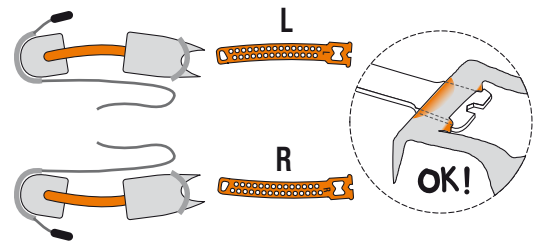

4. Attachment to the boots



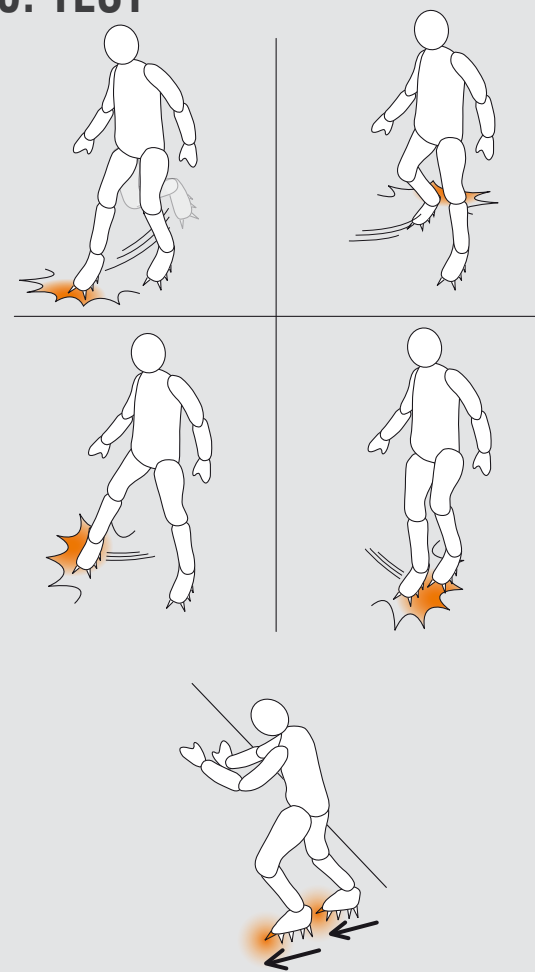



5. TEST



Spare parts / Pièces détachées : IRVIS SIDELOCK T03SL02

2 reversible linking bars L 2 barrettes reversibles L T20850	4,5 <  < 11,75 (US) 37 <  < 46 (FR)
---	--

2 reversible linking bars M 2 barrettes reversibles M T20950	junior 9,75 <  < 8,5 (US) 27 <  < 42 (FR)
---	---

2 curved linking bars L for asymmetrical boots 2 barrettes incurvées L pour chaussures asymétriques T10950	7,3/4 <  < 14,2/3 (US) 42 <  < 50 (FR)
---	---

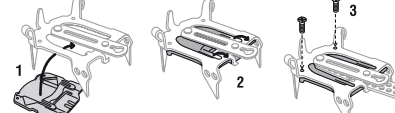
ANTISNOW antiballing 2 fronts + 2 rears Antibottage ANTISNOW 2 avants + 2 arrières T03960	
--	---

	
---	--

SIDELOCK strap kit Kit lanières SIDELOCK T10850	
--	---

2 toe bail safety straps 2 pattes de sécurité fil avant T10800	
---	---

Telemark front wires Fils avant télémarque T03600	
--	---